

## NPN General Purpose Amplifier

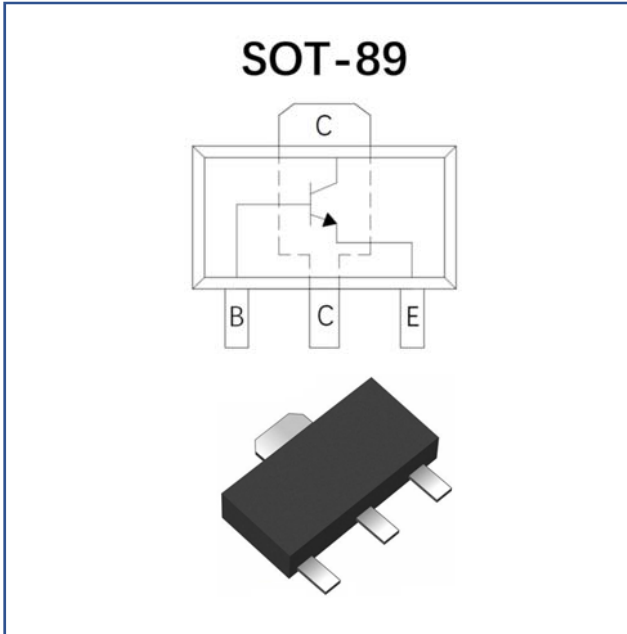

### Features

- Moisture sensitivity level 1
- Halogen free and RoHS compliant
- Surface mount package ideally suited for automatic Insertion

### Application

- Low saturation voltage
- High speed switching

### Mechanical data

- **Package:** SOT-89
- **Terminals:** Tin plated leads, solderable per J-STD-002 and JESD22-B102

### ■ Maximum Ratings ( $T_a=25^\circ\text{C}$ Unless otherwise specified)

Item	Symbol	Unit	Conditions	Value
Device marking code				C554
Collector-base voltage	$V_{CB0}$	V	$I_C=100\mu\text{A}, I_E=0$	100
Collector-emitter voltage	$V_{CE0}$	V	$I_C=1\text{mA}, I_B=0$	100
Emitter-base voltage	$V_{EB0}$	V	$I_E=100\mu\text{A}, I_C=0$	6
Collector current	$I_C$	A		2
Power dissipation	$P_D$	mW		500
Operation junction temperature	$T_J$	$^\circ\text{C}$		-55 to +150
Storage temperature	$T_{STG}$	$^\circ\text{C}$		-55 to +150



# 2SC554

RoHS  
COMPLIANT

## ■ Electrical Characteristics (T<sub>a</sub>=25°C Unless otherwise specified)

Item	Symbol	Unit	Conditions	Min	Typ	Max
Collector-base breakdown voltage	V <sub>(BR)CBO</sub>	V	I <sub>C</sub> =100μA, I <sub>E</sub> =0	100		
Collector-emitter breakdown voltage	V <sub>(BR)CEO</sub>	V	I <sub>C</sub> =1mA, I <sub>B</sub> =0	100		
Emitter-base breakdown voltage	V <sub>(BR)EBO</sub>	V	I <sub>E</sub> =100μA, I <sub>C</sub> =0	6		
Collector-base cut-off current	I <sub>CBO</sub>	μA	V <sub>CB</sub> =100V, I <sub>E</sub> =0			1
Emitter-base cut-off current	I <sub>EBO</sub>	μA	V <sub>EB</sub> =4V, I <sub>C</sub> =0			1
DC current gain	h <sub>FE</sub>		V <sub>CE</sub> =3V I <sub>C</sub> =100mA	82		270
Collector-emitter saturation voltage	V <sub>CE(sat)</sub>	V	I <sub>C</sub> =500mA I <sub>B</sub> =25mA			0.2
		V	I <sub>C</sub> =1A I <sub>B</sub> =50mA			0.3
Collector-base output capacitance	C <sub>ob</sub>	pF	V <sub>CB</sub> =10V, I <sub>E</sub> =0, f=1MHz		16	

## ■ Thermal Characteristics

Parameter	Symbol	Unit	Value
Thermal resistance, junction-to-ambient	R <sub>θJ-A</sub> <sup>(1)</sup>	°C/W	250
Thermal resistance, junction-to-case	R <sub>θJ-C</sub> <sup>(1)</sup>	°C/W	200

### Note:

(1) Device mounted on PCB, single-sided copper, with standard footprint



■ Characteristics

Fig 1: Static Characteristics

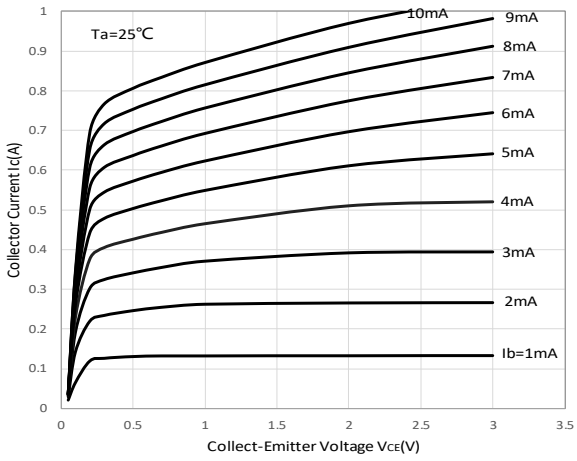

Fig 2: DC Current Gain

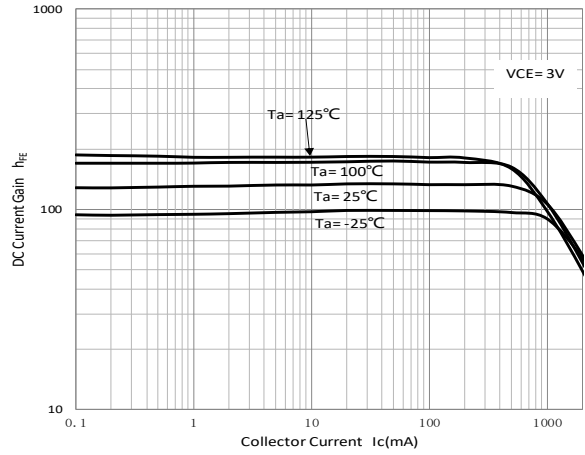

Fig 3: Collector-emitter saturation voltage

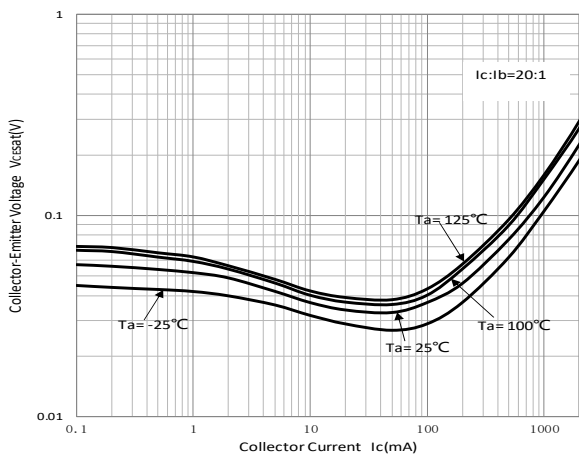

Fig 4: Base-emitter saturation voltage

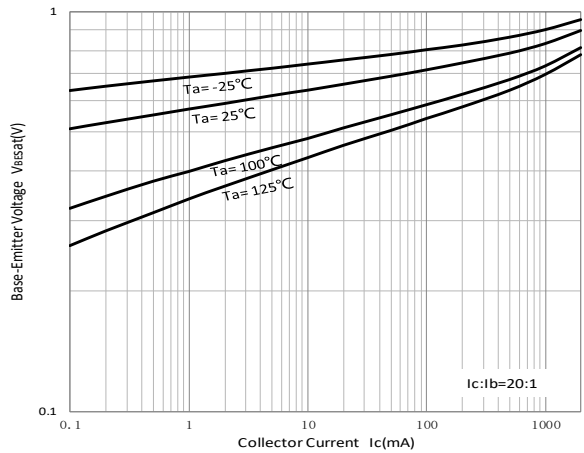

Fig 5: Base-emitter on voltage

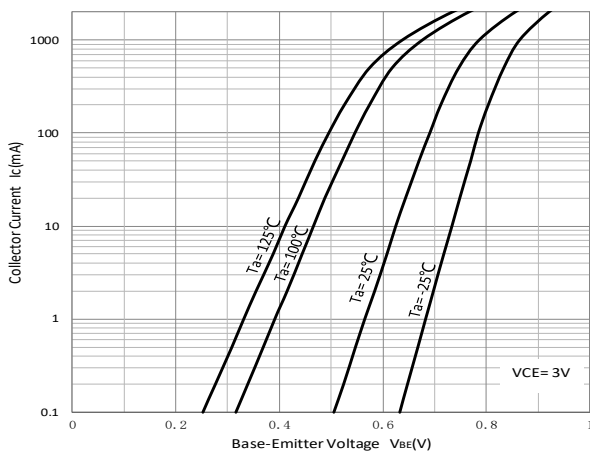

Fig 6: Cob/Cib-V<sub>CB</sub>/V<sub>EB</sub>

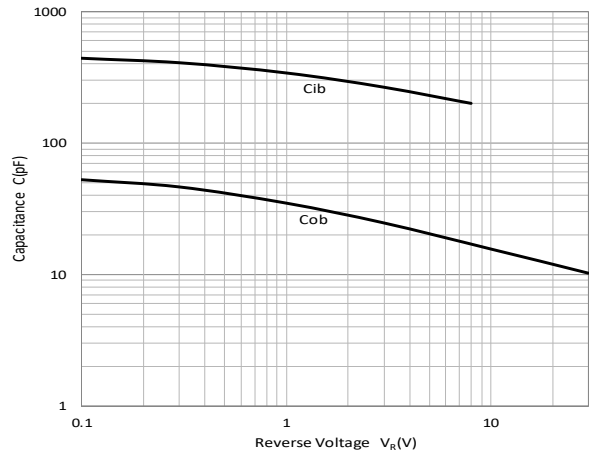
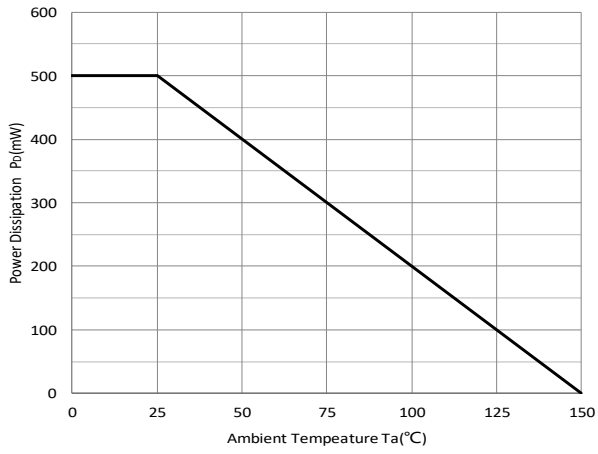



Fig 7:  $P_D$ - $T_a$  Curve





# 2SC554

RoHS  
COMPLIANT

## Ordering Information

Prefered P/N	Packing code	Unit weight(g)	Minimum package(pcs)	Inner box quantity(pcs)	Outer carton quantity(pcs)	Delivery mode
2SC554	F2	Approximate 0.055	1000	8000	32000	7" reel

## Outline Dimensions

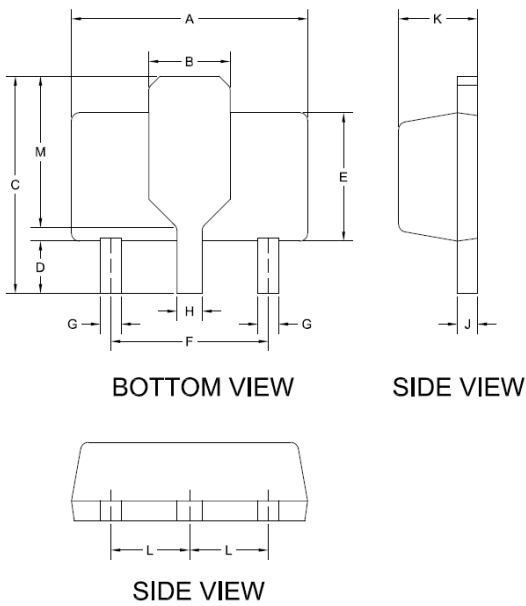

DIM	INCHES		MM	
	MIN.	MAX.	MIN.	MAX.
A	0.173	0.181	4.400	4.600
B	0.061 TYP.		1.550 TYP.	
C	0.155	0.167	3.940	4.250
D	0.031	0.047	0.800	1.200
E	0.094	0.102	2.400	2.600
F	0.118 TYP.		3.00 TYP.	
G	0.014	0.019	0.360	0.480
H	0.017	0.022	0.440	0.560
J	0.014	0.017	0.350	0.440
K	0.055	0.063	1.400	1.600
L	0.059 TYP.		1.500 TYP.	
M	0.108 TYP.		2.750 TYP.	

## Suggested Pad Layout

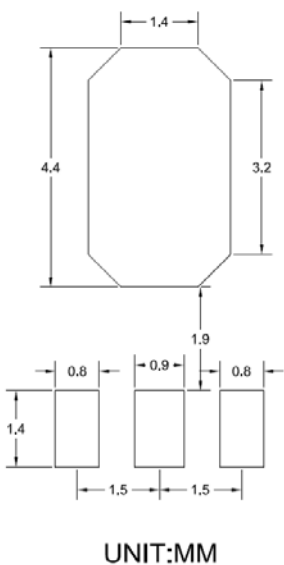



---

**Disclaimer**

The information presented in this document is for reference only. Yangzhou Yangjie Electronic Technology Co., Ltd. reserves the right to make changes without notice for the specification of the products displayed herein to improve reliability, function, or design or otherwise.

The product listed herein is designed to be used with ordinary electronic equipment or devices, and not designed to be used with equipment or devices which require high level of reliability and the malfunction of which would directly endanger human life (such as medical instruments, transportation equipment, aerospace machinery, nuclear-reactor controllers, fuel controllers and other safety devices), Yangjie or anyone on its behalf, assumes no responsibility or liability for any damages resulting from such improper use of sale.

This publication supersedes & replaces all information previously supplied. For additional information, please visit our website [http:// www.21yangjie.com](http://www.21yangjie.com) , or consult your nearest Yangjie's sales office for further assistance.